

York County Shore

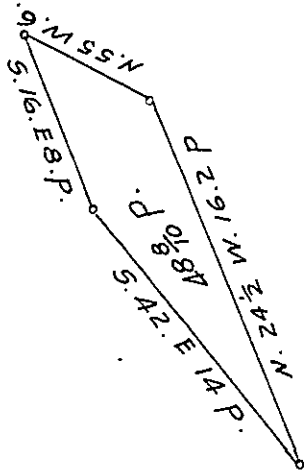

Lancaster County Shore

Draught of "D. Ridge Island" Situate in the River Susquehanna, in Conestogo Township, Lancaster County, Bounded between the lower end of Conestogo Island, & the upper end of Bottom Island - Containing forty eight perches and eight tenths of a perch, Strict Measure.

Surveyed in pursuance of a Warrant, granted to John Fesh, bearing date the 18th day of Sept: A.D. 1821.

Examined & Certified, the 23 day of March 1822

P. — Robert King J: D.S.

To Saml Cochran, Esqr.

Surveyor Genl.

IN TESTIMONY that the above is a copy of the original remaining on file in the Department of Internal Affairs of Pennsylvania, made conformably to an Act of Assembly approved the 16th day of February, 1833, I have hereunto set my Hand and caused the Seal of said Department to be affixed at Harrisburg, this twenty-second day of January 1907.

Joseph B. Brown
Secretary of Internal Affairs.